



Operating Instructions

Cassette Toilet for Recreation Vehicles

CT 3050

CTS 3050

CTW 3050

CTLP 3050

CT 3110

CTS 3110

CTW 3110

CTLP 3110



OPERATING INSTRUCTIONS

CASSETTE TOILET



Record for future reference:

Model number

Product number

Serial number

T.B. MBA 03/2008

N 2

English

Table of contents

1.0	General	4
1.1	Introduction	4
1.2	Guide to these operating instructions	4
1.3	Copyright protection	4
1.4	Explanation of symbols used in this manual	4
1.5	Limitation of liability	5
1.6	Warranty	5
1.7	Customer services	5
1.8	Spare parts	5
1.9	Environmental notices	5
1.10	Dometic sanitary additives	6
1.11	Declaration of conformity	6
2.0	Safety instructions	7
2.1	Intended use	7
2.2	User's responsibility	7
2.3	Use of sanitary additives	7
2.4	Working upon and checking the toilet	7
3.0	Description of model	8
3.1	Model identification	8
3.2	Toilet identification label	8
3.3	Technical data	8
3.4	Explanation of toilet	9
4.0	Using the toilet	10
4.1	Cleaning	10
4.2	Maintenance	10
4.2.1	Dismantling the cassette seal	10
4.3	Preparing cassette tank	11
4.4	Filling fresh water tank	12
4.5	Operation element and display	12
4.6	Using the toilet	12
4.7	Emptying the cassette tank	13
4.8	Exchanging the fuse on the control panel	14
4.9	Winter use	14
4.10	Decommissioning	14
4.11	Remove seat	15

1.0 General

1.1 Introduction

You have made an excellent choice in selecting this **Dometic** cassette toilet. We are sure that you will be satisfied with your new sanitation system in all respects. This toilet meets high quality standards and guarantees the efficient utilisation of resources and energy throughout its entire life cycle, during manufacture, in use and when being disposed of.

1.2 Information on this manual

Before operating the toilet read and understand the contents of this manual.

These instructions provide you with the necessary guidance for the proper use of the toilet. **Observe the safety instructions in particular.** Observing the instructions and handling recommendations is important for dealing with the toilet safely and for protecting you from injury and the toilet from damage. You must understand what you have read before you carry out a task..

Keep this manual in a safe place close to the toilet so it may be referred to at any time.

1.3 Copyright protection

The information, texts and illustrations in these instructions are copyright protected and are subject to industrial property rights. No part of these instructions may be reproduced, copied or utilised in any other way without written authorisation by Dometic GmbH, Siegen.

1.4 Explanation of symbols used in this manual

Warning notices

Warning notices are identified by symbols. A supplementary text gives you an explanation of the degree of danger.

Observe these warning notices rigorously. You will thus protect yourself and other people from injury, and the sanitation system from damage.



CAUTION!

CAUTION indicates a potentially hazardous situation which may result in minor or moderate injury if the given instructions are not adhered to.

CAUTION!

CAUTION (used without the safety alert symbol) indicates a potentially hazardous situation which may result in damage to the appliance if the given instructions are not adhered to.

Environmental tip



ENVIRONMENTAL TIP gives you useful guidance for saving energy and disposal of the sanitation system.

1.5 Limitation of liability

All information and guidance in these operating instructions were prepared after taking into consideration the applicable standards and regulations as well as the current state of the art. **Dometic** reserves the right to make changes at any time which are deemed to be in the interest of improving the product and safety.

Dometic will assume no liability for damage in the case of :

- non-observation of the operating instructions
- application not in accordance with the regulations or provisions
- use of non-original spare parts
- improper modifications and interferences to the appliance

1.6 Warranty

Warranty arrangements are in accordance with EC Directive 44/1999/CE and the normal conditions applicable for the country concerned. For warranty or other maintenance, please contact our customer services department. Any malfunction due to improper use is not covered by the warranty. The warranty does not cover any modifications to the appliance or the use of **non-original Dometic parts**. The warranty does not apply if the installation and operating instructions are not adhered to and no liability shall be entertained.

1.7 Customer services

Dometic offers a customer services network throughout Europe. Find your authorised customer service centre by calling the phone number indicated in the **EuroService**

Network booklet which comes with every toilet. You can also look up your closest customer services partner on the internet **www.dometic.com**.

When contacting Dometic Customer Services, please state the model, product number and serial number together with the MLC code, if applicable. You will find this information on the toilet identification label. We recommend that you note these details in the field provided on the front page of this operation manual.

1.8 Spare parts

Spare parts can be ordered throughout Europe from our customer services department.

Always state the model and product number when you contact customer services. You will find this information on the toilet identification label (see section 3.2“ *Toilet identification label*“)

1.9 Environmental notices



Use of sanitary additives

Please observe the usage notes on the packaging when using sanitary additives.

Disposal

In order to ensure that the recyclable packaging materials are re-used, they should be sent to the customary local collection system. The appliance should be transferred to a suitable waste disposal company that will ensure re-use of the recyclable components and proper disposal of the rest.

1.10 Dometic sanitary additives

In the "Dometic CARE" series, Dometic offers premium sanitary additives for your toilet. These products help to make using the toilet more comfortable and hygienic and are available at specialist dealers.



Fig. 1

■ Dometic Power CARE ①

Dometic Power CARE prevents the emergence of gas and unpleasant odours in the holding tank for up to four days..

- Available in 475-ml, 1-l or 2-l bottles.

■ Dometic Special CARE ②

Dometic Eco CARE is a green sanitary additive which prevents the emergence of unpleasant odours for up to four days and formation of sediments in the cassette tank.

- Available in 475-ml, 1-l or 2-l bottles.

■ Dometic Extra CARE ③

Dometic Extra CARE is a flush water additive which is suitable for all plastic surfaces. Dometic Extra CARE creates a smoother flush, makes cleaning the toilet bowl easier and protects the rubber seals. In addition, it creates a pleasant odour after flushing.

- Available in 475-ml, 1-l or 2-l bottles.

■ Dometic Quality CARE ④

Dometic Quality CARE is a powerful cleaning agent for all toilets bowls, whether they are

made from plastic or china. Dometic Quality CARE dissolves stains fast. Simply apply Dometic Quality CARE to the sides of the toilet bowl and under the rim, let it rest for a short time and brush away.



- Available in a 475-ml bottle.

■ Dometic Comfort CARE ⑤

The rapidly dissolving toilet paper Dometic Comfort CARE prevents clogging in the cassette tank and is nevertheless of a strong quality. It provides extra comfort with comfortable long paper sheets.

- 4 rolls per pack.

1.11 Declaration of conformity

 DECLARATION OF CONFORMITY	
according to Low Voltage Directive 73/23/EEC and the Amendment to LVD 90/683/EEC Automotive Directive 72/245/EEC and the Amendment 95/54/EC, 2006/28/EC CE Marking Directive 93/68/EEC End-of-Life Vehicle Directive 2000/53/EC RoHS Directive 2002/95/EC	
Type of equipment Brand Name Type family Manufacturer's (Factory) name address telephone no telefax no	Ceramic cassette toilet DOMETIC CT 3XXX DOMETIC GmbH In der Steinwiese 16, D-57074 Siegen INT+49 - 271 692 0 INT+49 - 271 692 304
The following harmonized standards or technical specifications (designations) which comply with good engineering practice in safety matters in force within the EEA have been practiced: following DIN EN 997 (12/2003) EN 55014-1,00, A1, A2 EN 55014-2,97, A1	
The equipment conforms completely with the above stated harmonized standards or technical specifications.	
By signing this document, the undersigned declares as manufacturer, or the manufacturer's authorized representative established within the EEA, that the equipment in question complies with the requirements stated above.	
Manufacturer Date 2008.01.11	Signature  Gunther Bittner Position General Manager

2.0 Safety instructions

2.1 Intended use

This toilet is designed for installation in recreation vehicles such as caravans or motorhomes.

2.2 User's responsibility

Anyone operating the sanitation system must be familiar with the safe handling and understand the advice in these operating instructions. Children may only operate the sanitation system if they have been made aware of how to operate it safely and the dangers attending incorrect operation.

2.3 Use of sanitary additives

Before using sanitary means when using and cleaning the toilet, observe the usage notes on the packaging.



CAUTION!

Store these sanitary additives so that they are out of the reach of children.

2.4 Working upon and checking toilet

Leave maintenance and service work to specialist staff.

Exception

Subj. 4.2.1. *Dismantling the cassette seal*

3.0 Description of model

3.1 Model identification

Example :

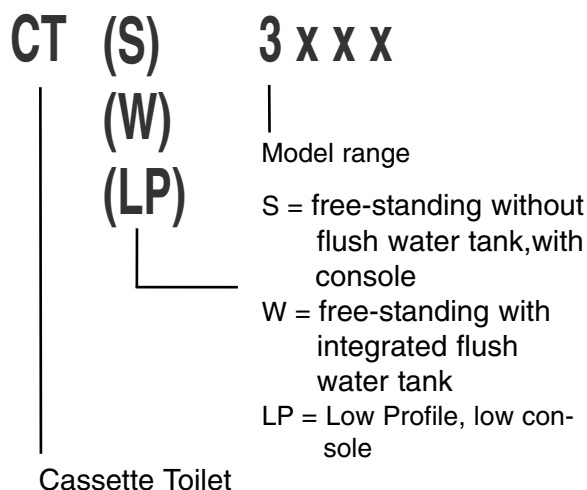

The CT 3xxx cassette toilet consists of a toilet which is installed fixed in the vehicle and a removable, mobile cassette as a faeces tank. The cassette can be accessed from the outside through a door. Depending on the model, the toilet receives the flush water from a tank integrated in the model or from a fresh water tank installed in the vehicle.

Four different models are available:

- **CT 3xxx** , free-standing, without water tank, without tank case
- **CTS 3xxx** , free-standing, without water tank, with tank case
- **CTW 3xxx** , free-standing, with water tank in tank case
- **CTLP 3xxx** , free-standing, without water tank, with low profile tank case

3.2 Toilet identification label

The identification label contains all important details. You can read off from this the model identification, the product number and the serial number. You will need these details whenever you contact the customer services centre or when ordering spare parts. You will find the identification label within the cassette housing after removing the cassette.

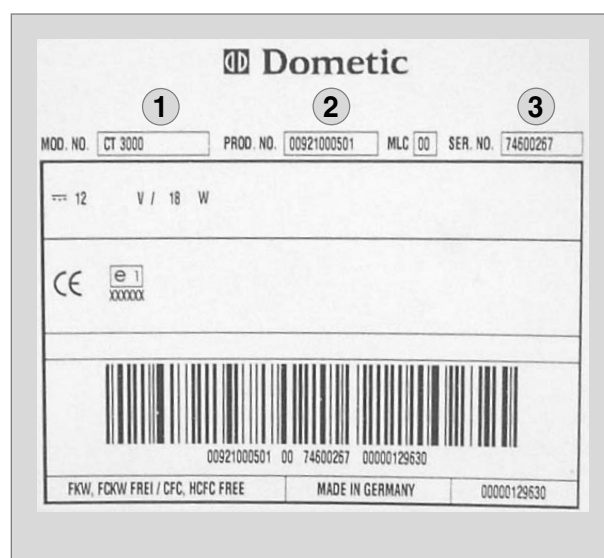

Fig. 2

- 1 Model number
- 2 Product number
- 3 Serial number

3.3 Technical data

Supply voltage : 12 V DC

Current consumption : max. 2 A with internal water pump, max. 5 A with external pump.

Dimensions : s. details in installation manual

Operating temperature : 0°C up to + 50°C

3.4 Description of components

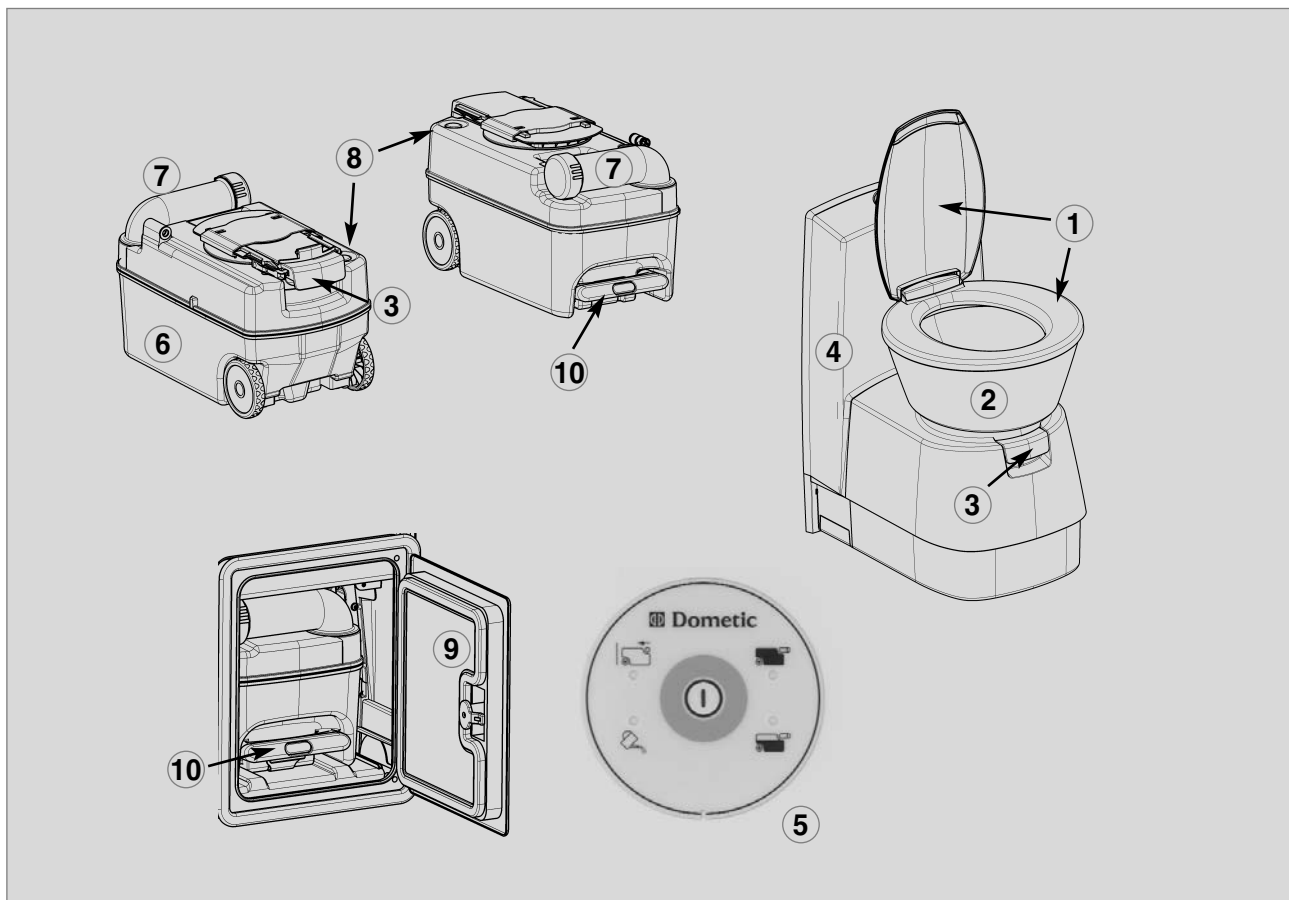

Fig. 3

- ① Removable cover and seat
- ② Toilet bowl
- ③ Emptying blade for the toilet bowl
- ④ Fresh water tank (capacity depends on the model)
- ⑤ Level indicator / flush (control panel)
- ⑥ Cassette tank (capacity 19 l)
- ⑦ Pour out spout
- ⑧ Vent button for emptying
- ⑨ Service door
- ⑩ Pull-out handle (cassette tank movable on wheels)

4.0 Using the toilet

4.1 Cleaning

Before using the toilet for the first time, we recommend cleaning the toilet on the inside and outside. Use a soft cloth and lukewarm water with a mild detergent. Then rinse the surfaces with clear water.

For regular cleaning, Dometic offers "Dometic Quality CARE", an effective toilet cleaning agent from the "Dometic CARE" range (see notes in Section 1.10) which is tailor-made for your toilet's surfaces.

4.2 Maintenance

Regularly clean all seals on the toilet and cassette tank.

Carry out this cleaning every month for frequent usage.

4.2.1 Dismantling the cassette seal

Remove the cassette tank and place it on a solid surface. Dismantle the entire blade, as illustrated in the following images. A seal can now be removed, cleaned or replaced.

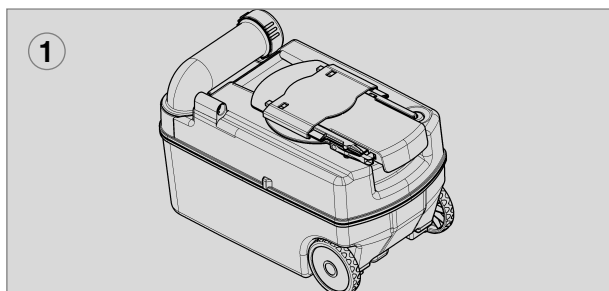

Fig. 4

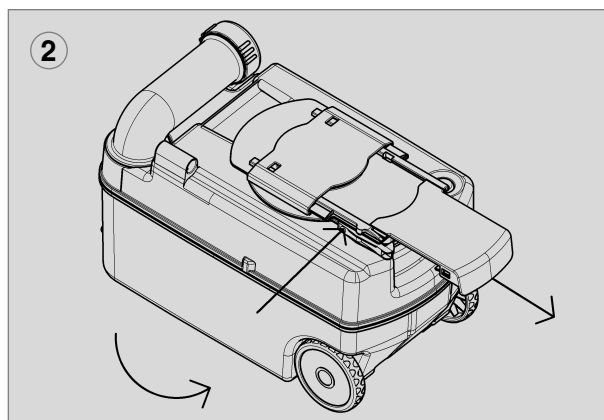

Fig. 5

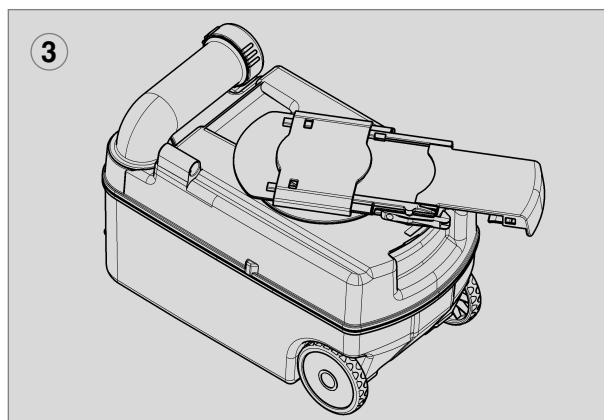

Fig. 6

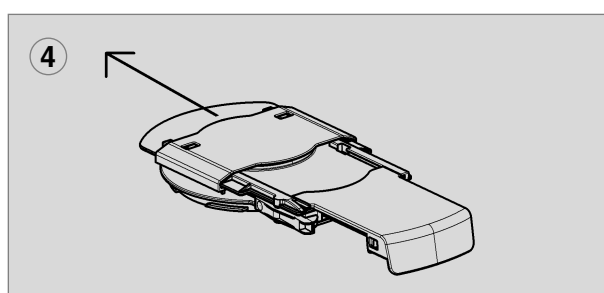

Fig. 7

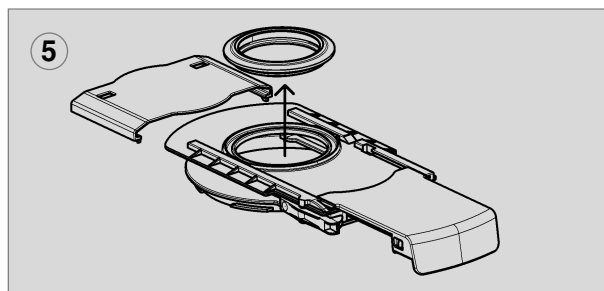

Fig. 8

4.3 Preparing cassette tank

Before you use the toilette for the first time:

- Open the service door.
- Unlock the cassette tank by pushing the lock upwards.

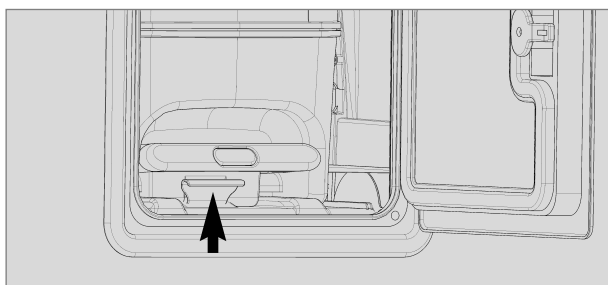

Fig. 9

- Pull the cassette out to the stop and remove it completely.

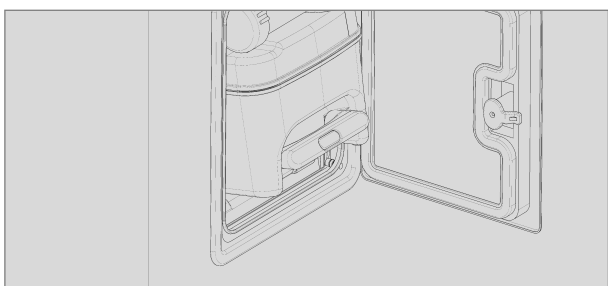

Fig. 10

- Place the cassette tank in an upright position and turn the pour out spout upwards by approx. 90°

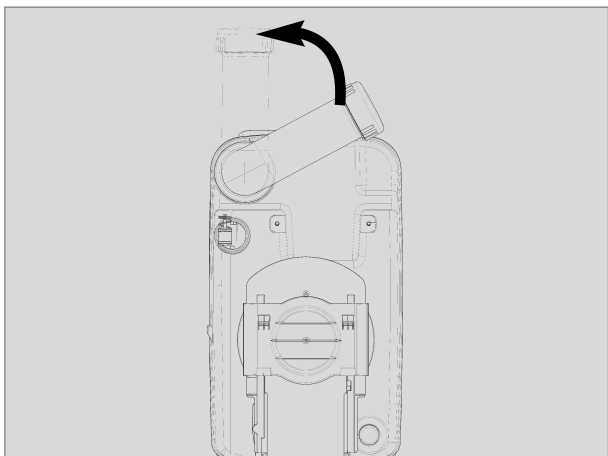

Fig. 11

CAUTION!

Avoid turning the spout by more than 90°, as it may otherwise come loose.



Fig. 12

- Fill a small amount of a Dometic sanitary additive (see notes in section 1.10) into the cassette tank via the spout.

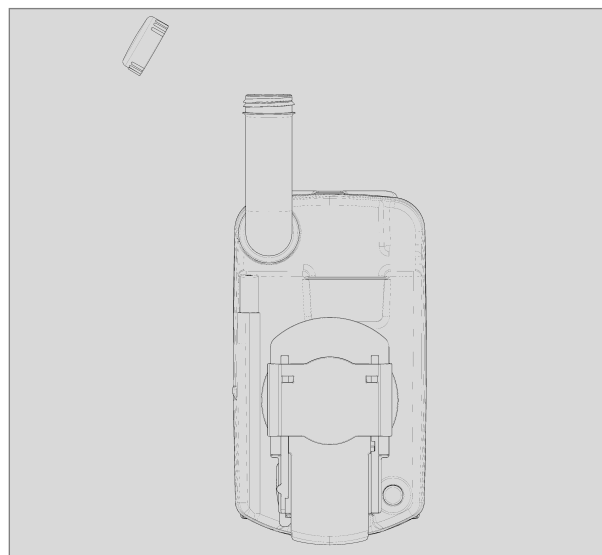

Fig. 13

- Put the cassette back in and push it in until it stops.

Ensure that the tank can be smoothly inserted. Do not use force!

- The tank's lock shuts automatically when inserted. But check that the cassette tank is firmly attached.

- Close and lock the service door.

4.4 Filling fresh water tank

Fill the fresh water tank via the filling piece on the outside of the vehicle. The quantity depends on the tank used (on-board tank or integrated toilet tank, option).

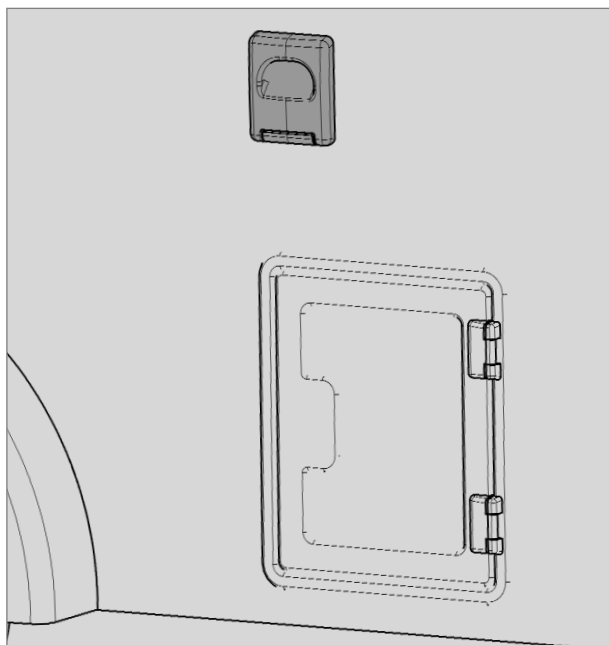

Fig. 14

4.5 Control panel

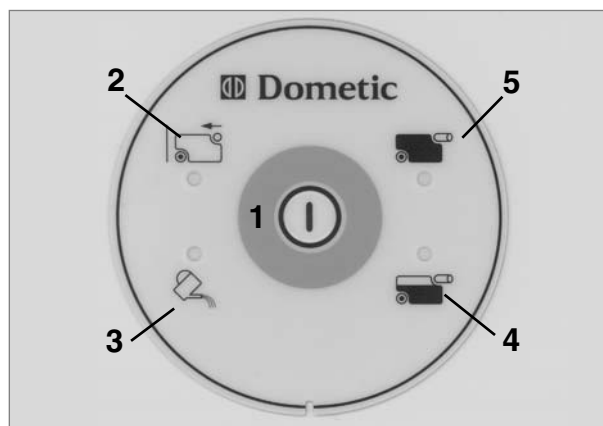

Fig. 15

1 = "Flush" button

2 = "Cassette tank removed" display

3 = "Fill fresh water tank" display*

4 = "Cassette tank 3/4 full" display

5 = "Cassette tank full" display

* not connected as a rule when using the on-board tank.

4.6 Using the toilet

- Run some water into the bowl by pressing the flush button (1).

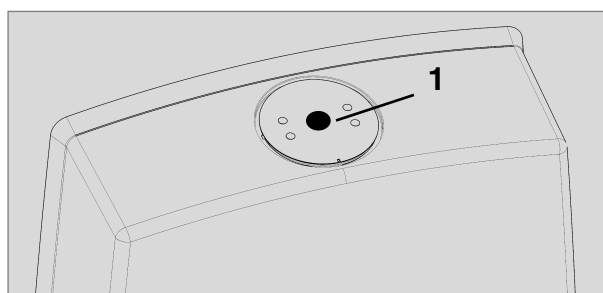

Fig. 16

- Open the blade (2) and flush the toilet after usage.

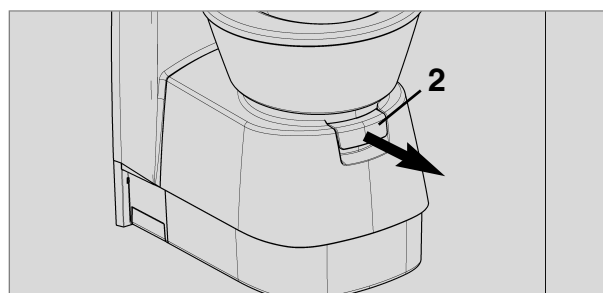

Fig. 17

4.7 Emptying the cassette tank

Empty the cassette tank when the level indicator LED lights up.

The cassette tank has a capacity of 19 l. When LED 4 lights up, the tank is approx. 80 % full. This means that it can be used only a couple of times.

- Remove the cassette tank as described in section "4.3".
- Carry or wheel the holding tank to the nearest authorized waste disposal point.

The cassette tank is provided with wheels and a pull-out handle. To unlock the handle, push in the button in middle of the handle. Pull out the handle until it stops.

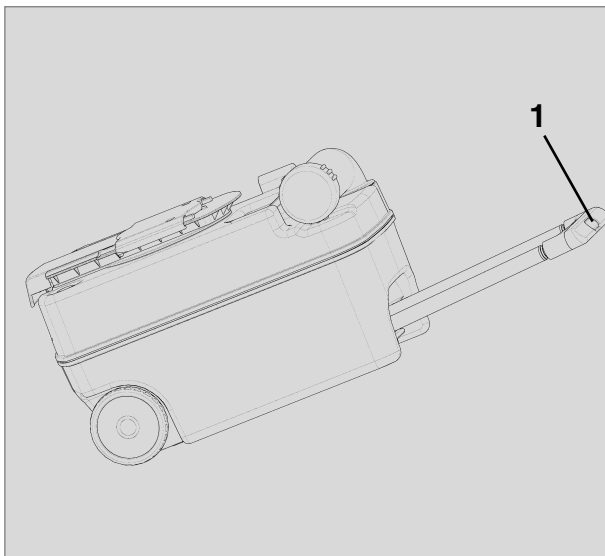

Fig. 18

To bring the handle back into its original position, press the handle's unlock key and push the handle back into the cassette.

- Place the cassette tank in an upright position and turn the emptying spout upwards. Remove the cap from the spout.

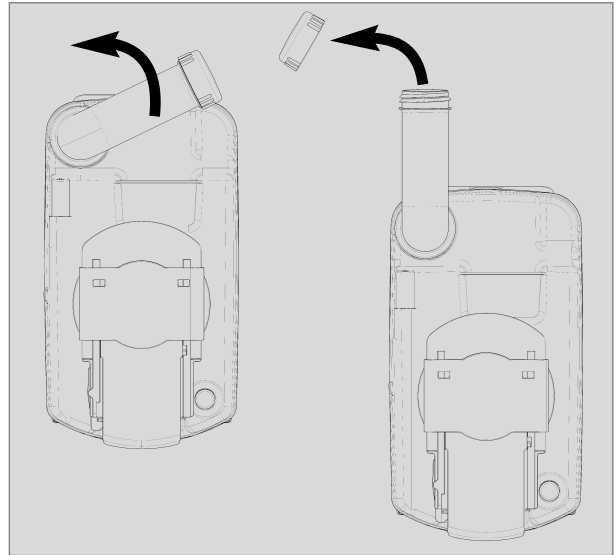

Fig. 19

CAUTION!

Avoid turning the spout by more than 90°, as it may otherwise come loose.



Fig. 20

- Hold the cassette tank with one hand by the handle (2). With the other hand hold it at the blade handle (3) so that you can operate the vent button (1) during emptying.

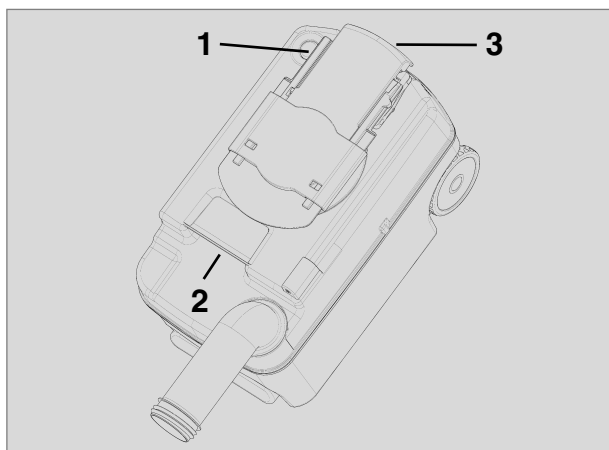

Fig. 21

- The vent button should only be pressed once the emptying spout is pointing downwards. The tank empties evenly and without squirting.
- After emptying, flush the cassette tank thoroughly with water. Then make the tank operational again as described in section "4.3", before inserting it in the toilet.

4.8 Exchanging the fuse on the control panel

Lift the control panel with a suitable tool and pull it out of the the tank case or the wall. The fuse (automotive fuse : 7.5 A) is located on the bottom side of the control panel.

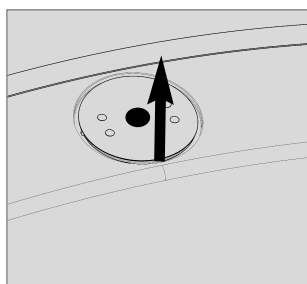

Fig. 22

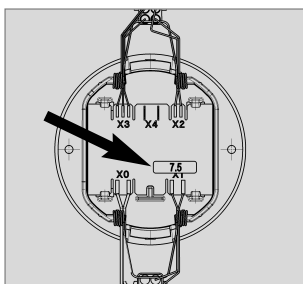

Fig. 23

4.9 Winter use

You can continue to use the cassette also in winter, as long as the toilet and the cassette are situated in a frost-protected location.

If this is not the case, empty the fresh water tank, the cassette tank and the water pipes of fresh water supply. This prevents damage due to frost (see "4.10 Decommissioning").

CAUTION!

Do not use anti-freeze agents. Such agents can damage the sanitation system.

4.10 Decommissioning

If you wish to decommission the toilet for long periods of time, empty the fresh water tank and the water supply system fully.

- Clean the toilet with Dometic Quality Care.
- Press the flush button until there is no remaining water left in the pipes.
- Then empty the cassette tank and rinse it thoroughly.
To allow the tank to dry, do not place the cap back on the emptying spout of the waste tank.

4.11 Remove seat

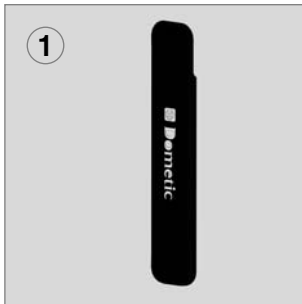

Fig. 24

Tool /
accessory

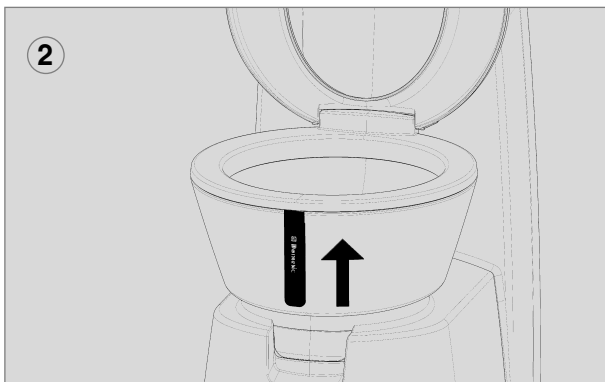

Fig. 25

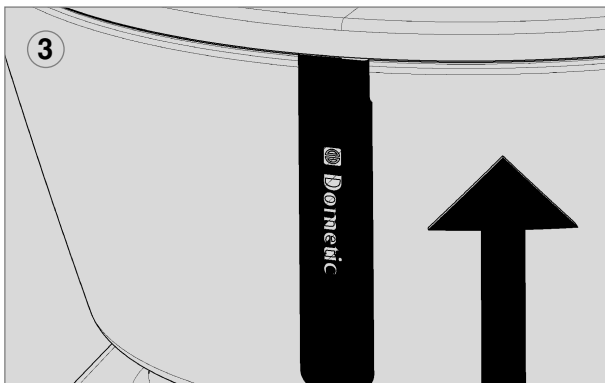

Fig. 26

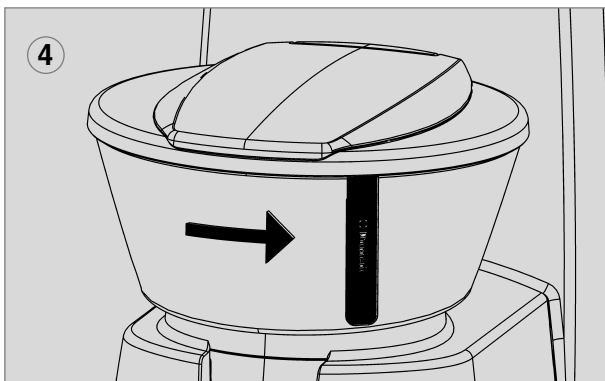

Fig. 27

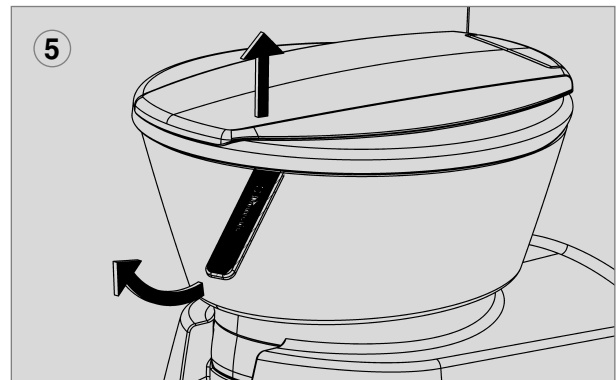

Fig. 28

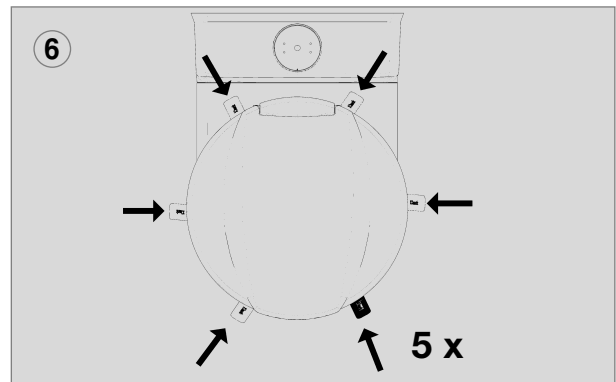

Fig. 29

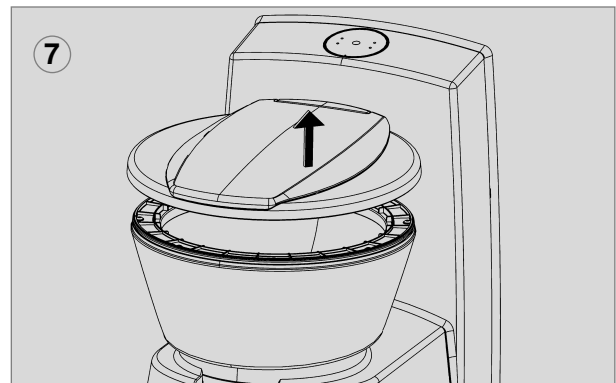

Fig. 30

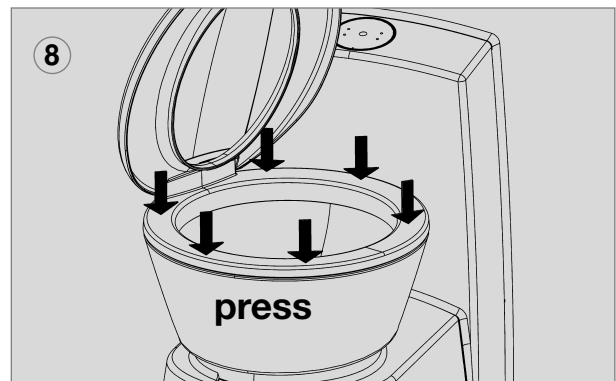

Fig. 31



Dometic GmbH
In der Steinwiese 16
D-57074 Siegen

www.dometic.com